

# IGS-182GP

**Industrial 8+2 port unmanaged Ethernet switch with 8x10/100/1000Base-T(X) with 2x100/1000Base-X SFP port**

## Features

- Supports 8 ports 10/100/1000 Base-T(X)
- Support 2 ports 100/1000Base-X
- Supports auto-negotiation and auto-MDI/MDI-X
- Supports store and forward transmission
- Supports flow control
- Compact size for easily installation
- Rigid IP-30 housing design
- DIN-Rail and wall mounting enabled



## Introduction

IGS-182GP is unmanaged Ethernet switch with 8x10/100/1000Base-T(X) with 2x100/1000Base-X ports. With very compact size of housing, you can install IGS-182GP easily. In addition, IGS-182GP is with rigid IP-30 housing design and can operate under harsh environment. The extended operating temperature range from -40°C to 75°C is ready and can satisfy most requirement of operation.

## Dimension

Unit = mm (Tolerance  $\pm 0.5\text{mm}$ )

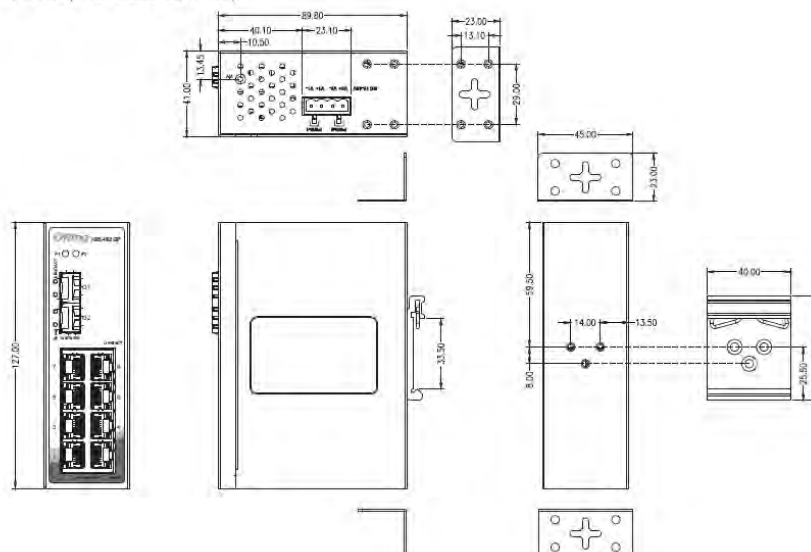

## Specifications

ORing Switch Model	IGS-182GP
<b>Physical Ports</b>	
10/100/1000 Base-T(X) Ports in RJ45 Auto MDI/MDIX	8
100/1000Base-X ports	2
<b>Technology</b>	
Ethernet Standards	IEEE 802.3 for 10Base-T IEEE 802.3u for 100Base-TX and 100Base-FX IEEE 802.3ab for 1000Base-T IEEE 802.3z for 1000Base-X IEEE 802.3x for Flow control
MAC Table	4K
Processing	Store-and-Forward
Switch Latency	<7us
Switch Bandwidth	20G bps
Packet buffer size	1.5M bits
Jumbo Frame	9216 Bytes
<b>LED indicators</b>	
Power Indicator	Green for PWR1, PWR2
10/100/1000Base-T(X) RJ45 Port Indicator	Upper for Link/Act indicator, Green for port Link/Act. Lower for speed indicator, Green for 1000Mbps, Amber for 100Mbps, OFF for 10Mbps
100/1000Base-X SFP Port Indicator	Upper for Link/Act indicator, Green for port Link/Act. Green for 1000Mbps, Amber for 100Mbps
<b>Power</b>	
Input Power	Dual 12~48 VDC voltage power input on 4-pin terminal block
Power Consumption (Typ.)	<5Watts, 12-48VDC: 0.41A-0.11A
Overload Current Protection	Present
Reverse Polarity Protection	Present
<b>Physical Characteristic</b>	
Enclosure	IP-30, Metal
Dimension (W x D x H)	41 (W) x 89.8 (D) x 127 (H)mm
Weight (g)	400g
<b>Environmental</b>	
Storage Temperature	-40 to 85°C (-40 to 185°F)
Operating Temperature	-40 to 75°C (-40 to 167°F)
Operating Humidity	5% to 95% Non-condensing
<b>Regulatory approvals</b>	
EMC	CE EMC (EN 55024, EN 55032), FCC Part 15 B
EMI	EN 55032, CISPR32, EN 61000-3-2, EN 61000-3-3, FCC Part 15 B class A
EMS	EN 55024 (IEC/EN 61000-4-2 (ESD: Contact 6KV, Air 8KV), IEC/EN 61000-4-3 (RS: 3V), IEC/EN 61000-4-4 (EFT Power 2KV, Signal 2KV), IEC/EN 61000-4-5 (Surge: Power 1KV, RJ45 1KV), IEC/EN 61000-4-6 (CS: 3V), IEC/EN 61000-4-8(PFMF), IEC/EN 61000-4-11 (DIP))
Shock	IEC60068-2-27
Free Fall	IEC60068-2-31
Vibration	IEC60068-2-6
Safety	UL61010-1;UL61010-2-201
MTBF	1056,516 hours
Warranty	5 years

## Ordering Information

**IGS-1ABGP**

Code Definition	10/100Base-T(X) Port Number	Additional Port Number
Option	- 8: 8 ports	- 0: 0 port

Available Model	Model Name	Description
	IGS-182GP	Industrial 8-port unmanaged Ethernet switch with 8x10/100/1000Base-T(X) with 2x100/1000Base-X SFP ports

## Packing List

- IGS-182GP x 1
- Wall-mount Kit x 1
- Quick Installation Guide x 1
- Din-Rail Kit x 1

## Optional Accessories

- PAE-121000, 12VDC/1000mA 12W Power Adapter with universal 100 to 240VAC input, EU plug
- SDR/DRP Series DIN-Rail power supply
- PAA-121000, 12VDC/1000mA 12W Power Adapter with universal 100 to 240VAC input, US plug